

Electrical Equipment (Cont)

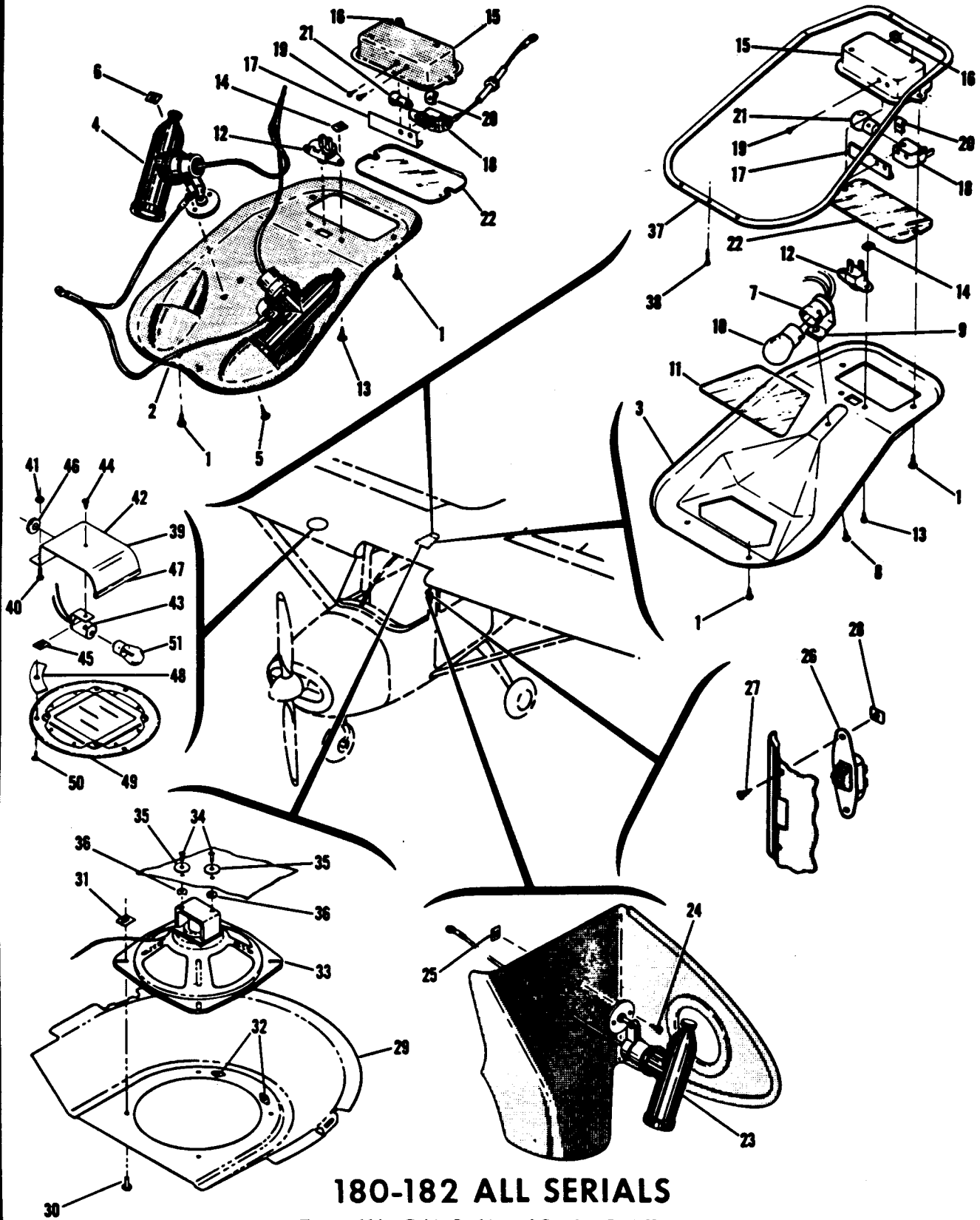

180-182 ALL SERIALS
Figure 114. Cabin Lights and Speaker Installation

FIGURE AND INDEX NO.	PART NUMBER	DESCRIPTION	UNITS PER ASSY	USABLE ON CODE
114-		CABIN LIGHTS, SPEAKER & COURTESY LIGHT INSTALLATION -----	NP	
	0710101-3	SHIELD ASSEMBLY-INSTRUMENT LIGHT -----	1	
	0710103-3	LIGHT ASSEMBLY-INSTRUMENT PANEL FLOOD -----	1	A
	0710103-10	LIGHT ASSEMBLY-INSTRUMENT PANEL FLOOD -----	1	K
		ATTACHING PARTS -----		L
- 1	S-10212-6-6	SCREW CESSNA STANDARD -----	2	

- 2	0710101-1	PLATE-COVER -----	1	A
- 3	0710103-5	PLATE-COVER -----	1	K
	0710103-11	PLATE-COVER -----	1	L
- 4	0713017-21	SPOTLIGHT ASSEMBLY -----	2	C
	0713017	LIGHT ASSEMBLY-INSTRUMENT -----	2	D
		ATTACHING PARTS -----		
- 5	S-10212-6-8	SCREW CESSNA STANDARD -----	1	
- 6	NAS446-2-3	NUT TIN A1181-62-3 -----	1	

- 7	MS15570-5	BULB -----	1	
	0513208-1	SOCKET -----	1	B
		ATTACHING PARTS -----		
- 8	S-10212-6-6	SCREW CESSNA STANDARD -----	1	
- 9	NAS446-2-3	NUT TIN A1181-62-3 -----	1	

- 10	MS15584-2	BULB -----	1	B
- 11	0710103-2	LENS -----	1	B
- 12	0713029	SWITCH -----	1	
		ATTACHING PARTS -----		
- 13	S-10212-6-6	SCREW CESSNA STANDARD -----	2	
- 14	NAS446-2-3	NUT TIN A1181-62-3 -----	2	

	0413142-4	LIGHT ASSEMBLY-DOME -----	1	G
	0413142-5	LIGHT ASSEMBLY-DOME -----	1	H
- 15	0413140	REFLECTOR -----	1	
- 16	MS35489-4	GROMMET -----	1	
- 17	0413140-2	RETAINER -----	1	
- 18	0413138	SOCKET -----	1	
		ATTACHING PARTS -----		
- 19	S-10212-4-4	SCREW CESSNA STANDARD -----	2	
- 20	NAS395-1-3	NUT TIN A6187-42-3 -----	2	

- 21	1816	BULB -----	1	
- 22	0413141-1	LENS -----	1	
- 23	0713017-22	SPOTLIGHT ASSEMBLY-MAP -----	1	
		ATTACHING PARTS -----		
- 24	S-10212-6-8	SCREW CESSNA STANDARD -----	2	
- 25	NAS446-2-3	NUT TIN A1181-62-3 -----	2	

	MS15570-5	BULB -----	1	
- 26	0713029	SWITCH-MAP LIGHT -----	1	
		ATTACHING PARTS -----		
- 27	S-10212-4-6	SCREW CESSNA STANDARD -----	2	
- 28	NAS446-1-3	NUT TIN A1776-42-3 -----	2	

- 29	0413238	HEADSET-SPEAKER-MICROPHONE INSTALLATION -----	NP	E
		RAFFLE ASSEMBLY-RADIO SPFAKFR -----		
		ATTACHING PARTS -----		
- 30	S-10212-8-8	SCREW CESSNA STANDARD -----	4	
- 31	NAS446-4-3	NUT TIN A1778-82-3 -----	4	

- 32	NAS444-1	NUTPLATE TIN A6191-62-3 -----	2	
- 33	0411062-4	SPEAKER-RADIO -----	1	
		ATTACHING PARTS -----		
- 34	AN515-RR8	SCREW -----	2	
- 35	0311001-27	WASHER-CORK CESSNA STANDARD -----	2	
- 36	AN970-3	WASHER -----	2	

**180-182
ALL SERIALS**

CONTINUED ON PAGE 310

FIGURE AND INDEX NO.	PART NUMBER	DESCRIPTION	UNITS PER ASSY	USABLE ON CODE
			1 2 3 4 5 6 7	
114-	0411062-4	HEADSET-SPEAKER-MICROPHONE INSTALLATION ----- SPEAKER-RADIO ----- ATTACHING PARTS -----	NP 1	F
	AN515-8R5 0311001-27 AN970-3	SCREW ----- WASHER ----- WASHER ----- -----*	2 2 2	
- 37	1200130-1	PLATE-HEADLINER RETAINER ----- ATTACHING PARTS -----	1	J
- 38	S-10212-6-6	SCREW CESSNA STANDARD ----- -----*	1	
- 39	0700616-1	COURTESY LIGHT INSTALLATION ----- SHIELD ASSEMBLY ----- ATTACHING PARTS -----	NP 1	
- 40	AN515-6R8	SCREW -----	2	
- 41	MS20365-632C	NUT ----- -----*	2	
- 42	0700616-2	SHIELD -----	1	
- 43	0513208-1	SOCKET ----- ATTACHING PARTS -----	1	
- 44	S-10212-6-8	SCREW -----	1	
- 45	NAS446-2-3	NUT ----- -----*	1	
- 46	MS35489-134	GROMMET -----	1	
- 47	S-1055-1-2.25	CHANNEL -----	1	
- 48	0700617-1	SPACER -----	1	
- 49	0700618-1	PLATE ASSEMBLY ----- ATTACHING PARTS -----	1 1	
- 50	S-10212-8-8	SCREW ----- -----*	3	
- 51	MS15584-2	LAMP -----	1	
<p>A---180 SERIAL 30000 THRU 50355 182 SERIAL 33000 THRU 51556 B---180 SERIAL 50356 & ON 182 SERIAL 51557 & ON C---180 SERIAL 30000 THRU 50355 D---182 SERIAL 33000 THRU 51556 E---180 SERIAL 30000 THRU 32150 F---180 SERIAL 32151 & ON 182 SERIAL 33000 & ON G---180 SERIAL 30000 THRU 50401 182 SERIAL 33000 THRU 51660 H---180 SERIAL 50402 & ON 182 SERIAL 51661 & ON J---180 SERIAL 18050912 & ON 182 SERIAL 18253008 & ON K---180 SERIAL 50356 THRU 18051020 182 SERIAL 51557 THRU 18253342 L---180 SERIAL 18051021 & ON 182 SERIAL 18253343 & ON NOTE. FOR ACCESSORY KIT LISTINGS REFER TO PAGES 372 THRU 374R S-NOS APPEARING ON THIS PAGE ARE CESSNA STANDARD</p>				